

WINDSOR



3010 SAVANNAH PLACE



3010 SAVANNAH PLACE

Located along the southern perimeter of the golf course where sweeping views over Windsor’s lakes and links, are truly magnificent, this home offers a setting that is both gracious and tranquil. Its harmonious atmosphere is elevated by design that thoughtfully aligns centerlines and axes, focusing attention on key visual elements. A raised garden and fountain in the auto court frame the formal entry to the home. The view corridor continues inside with the spacious foyer opening to the living room, which in turn opens through French doors to a colonnaded loggia overlooking the pool and the golf course. The classical layout is paired with airy interiors that emphasize natural light.

| | |
|-----------------|----------------------------|
| BEDROOMS | 6 |
| BATHROOMS | 5 FULL, 2 HALF |
| A/C SPACE | 6,578 SQ FT |
| NON-A/C SPACE | 3,024 SQ FT |
| ADJUSTED SPACE* | 8,090 SQ FT |
| LOT TYPE | COUNTRY ESTATE |
| LOT SIZE | 24,824 SQ FT |
| LOCATION | BLOCK 15 / LOT 7 |
| ARCHITECT | MOULTON LAYNE, P.L. |
| BUILDER | CROOM CONSTRUCTION COMPANY |
| YEAR BUILT | 2004 |

**Adjusted Space equals A/C space plus 50% of non-A/C space*

COUNTRY ESTATE

As a Country Estate, this home is located along the perimeter of the golf course, is set on one of Windsor's largest properties, and is surrounded by landscaped grounds. While Country Estates enjoy the most permissive building code requirements, all incorporate a few common elements on their golf course-side façades in order to create architectural interest and visual harmony. Those elements include wide ground-floor porches or loggias and low masonry walls.

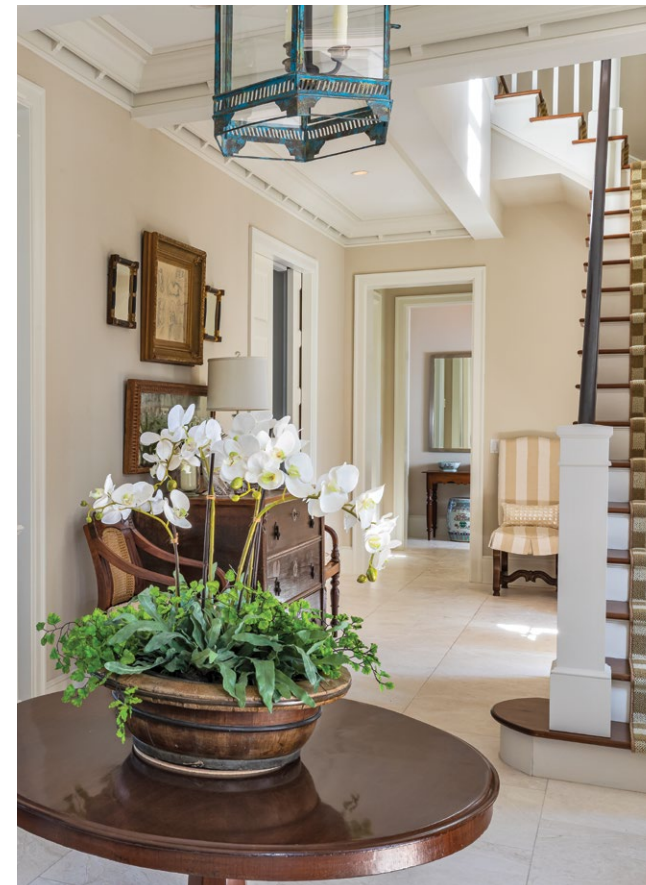

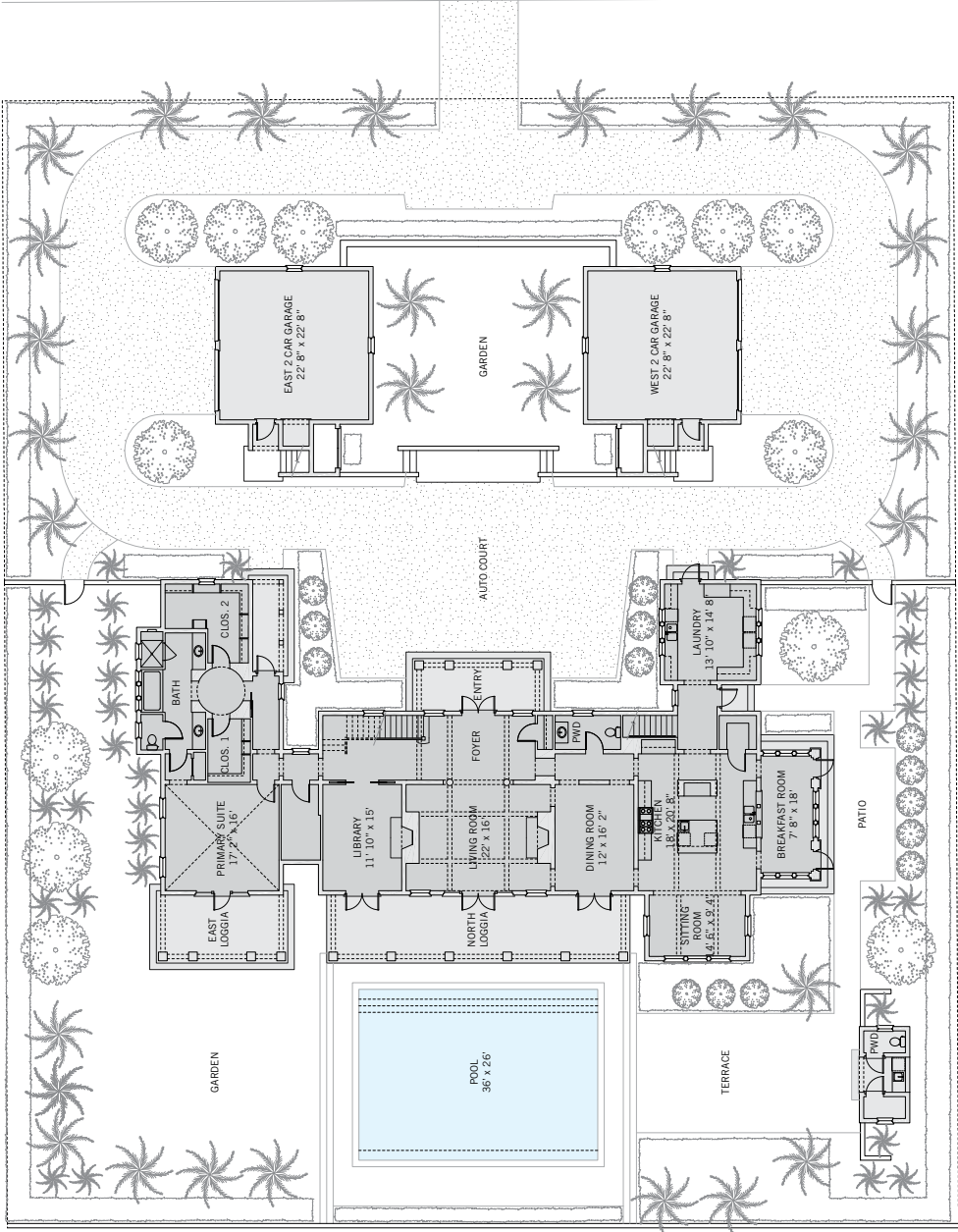

These drawings, colors and floor plans are conceptual only and are for the convenience of reference. They should not be relied upon as representation, express or implied, of final detail. The developer expressly reserves the right to make modifications, revisions and changes which it deems desirable in its sole and absolute discretion.

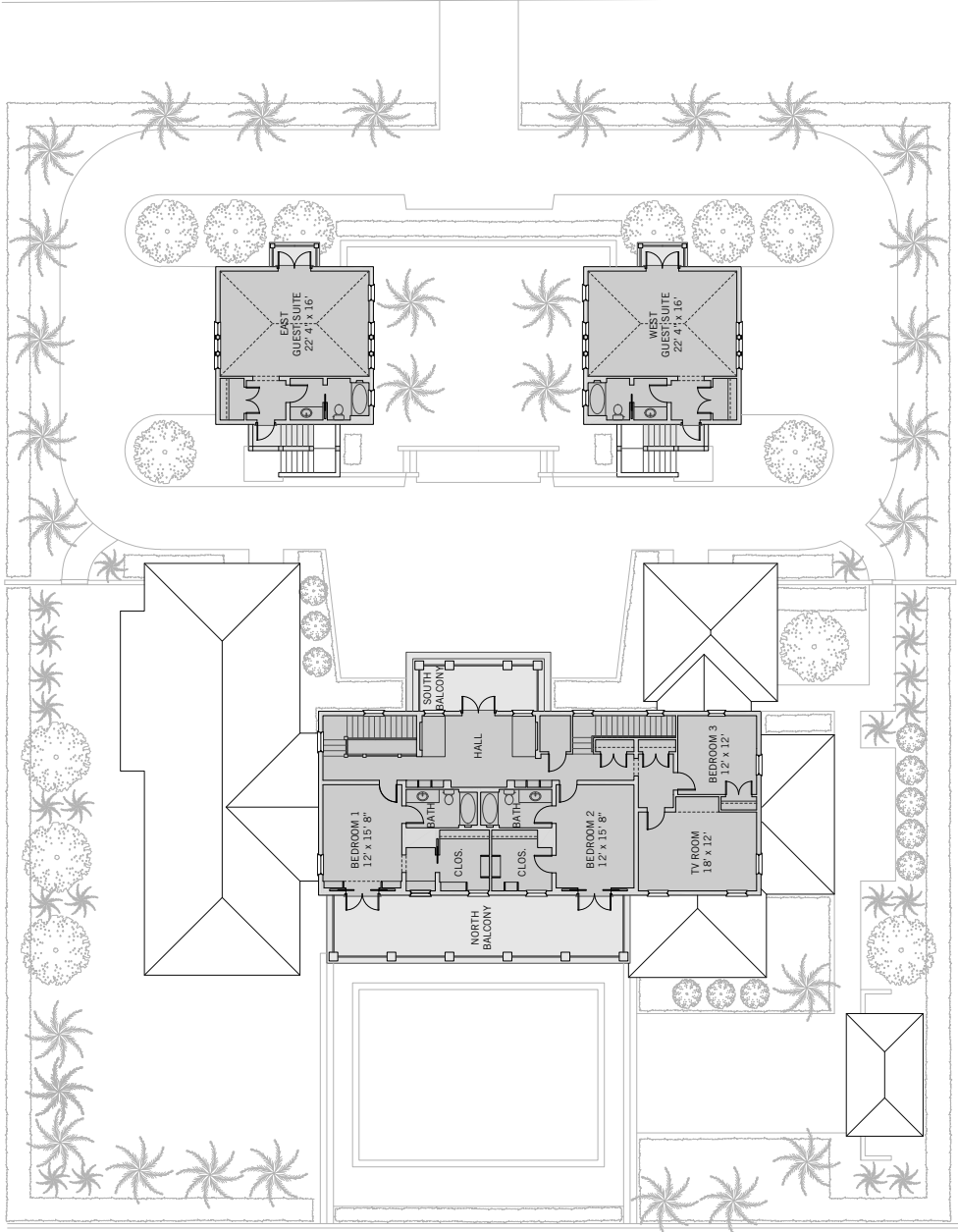



LIVING & ENTERTAINING

With a living room, dining room, and library all opening to a deep, covered and colonnaded loggia, this home is ideally suited to indoor-outdoor living and entertaining. Off of the kitchen, a breakfast room with herringbone pattern brick floors enjoys exceptional natural light via three exposures of tall casement windows and windowed doors. The terrace features an infinity-edge pool overlooking the golf course and a cabana with a wet bar that is perfectly equipped for poolside refreshments. Extensive and exquisitely crafted interior millwork includes coffered ceilings in the foyer and living room, shiplap walls in the kitchen, and casework in the library.



PRIVATE SUITES

The ground floor primary bedroom suite features vaulted coffered ceilings and opens to a private covered loggia with golf course views. The primary bathroom opens to separate his and hers walk-in closets. The second floor offers three additional bedrooms, two of which open to a covered veranda with golf course views. Guest suites occupy the second floor of the pair of carriage houses that flank and overlook the landscaped entry courtyard of the home. Each has an en-suite bathroom and a private balcony with south views over the Jungle Trail.





DESIGN DETAILS & FINISHES

PROPERTY & ARCHITECTURE

- Village location along the southern perimeter of the golf course
- Six bedrooms, five full bathrooms, two powder rooms
- Two garages
- Large laundry/mud room with brick floors and ample storage

OUTDOOR LIVING

- Landscaped auto court with raised garden and royal palm trees
- Terrace with pool and fountain
- Poolside cabana with wet bar, powder room and storage
- Covered loggia accessible from the dining room, living room and library

INDOOR LIVING

- Foyer with coffered ceilings
- Living room with coffered ceilings and fireplace opens to the poolside loggia through mahogany French doors
- Dining room opens to the poolside loggia through mahogany French doors
- Library with built-in book cases and fireplace opens to the poolside loggia through mahogany French doors

INDOOR LIVING CONTINUED

- Kitchen with shiplap walls and sitting room overlooking the pool terrace and golf course features a walk-in pantry and prep-island
- Breakfast room with herringbone pattern brick floor has three exposures and opens to the garden via two windowed doors
- Second floor hallway with built-in cabinetry and seating

GROUND-FLOOR SUITE

- Primary Bedroom with peaked coffered ceiling opens to a private covered porch overlooking the golf course
- Primary Bathroom with two vanities, bathtub overlooking the garden and separate shower
- Expansive his and hers walk-in closets open from a round vestibule off of the bath

SECOND-FLOOR SUITES

- Two guest suites, each with en-suite bathroom and walk-in closet, opening to a shared covered veranda
- Third guest suite and TV room

GUEST COTTAGES

- Two guest cottages, each with an en-suite bedroom and a private balcony

A VILLAGE BY THE SEA

Located in Vero Beach along Florida's Treasure Coast, Windsor is a private residential community and sporting club with a uniquely enchanting lifestyle. Across more than 470 lush acres, nestled between the Atlantic Ocean and the Indian River, Members and guests enjoy a host of exclusive amenities, including beach and golf clubs, a links-style golf course, tennis and equestrian centers and fine and casual dining restaurants.



AMENITIES

1. VILLAGE CENTRE
2. FITNESS & WELLNESS CENTRE
3. TOWN HALL
4. EQUESTRIAN CENTRE
5. BEACH CLUB
6. POLO FIELD
7. CROQUET GREENSWARD
8. TENNIS CENTRE
9. CLUBHOUSE
10. THE GALLERY



10680 BELVEDERE SQUARE VERO BEACH FLORIDA 32963

TEL 772 388 8400 OR 800 447 7347

WINDSORFLORIDA.COM